

## Lower ground floor | ARENA

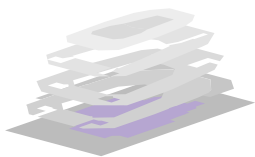

The imposing Arena building is the ideal venue for your event, whether it be a meeting, trade fair, congress or concert. Supporting events can be held in the Arena, such as mobility roadshows (test drives and economy test drives with two-wheeled and four-wheeled electric vehicles).



### Room description

Seating options	Capacity	
Concert	2000 People	
Seminar (incl. tables)	1000 People	
Banquet (incl. tables)	1500 People	
Standing room only	4000 People	
Gala	1000 People	
<b>Floor space</b>	Approx. 3000 m <sup>2</sup>	<b>Height</b> 3.5 m / 7 m / 12 m
<b>Floor load-bearing capacity</b>	1500 kg/m <sup>2</sup>	



Indoor road tests on two-wheelers



Customer appreciation day, Siemens, November 2012



Swiss Climate Pioneers, Swisscom, November 2012



AboutFleet, A+W Medien AG, November 2012

[www.umweltarena.ch](http://www.umweltarena.ch)  
[www.facebook.com/umweltarena](https://www.facebook.com/umweltarena)



Patronat: Kanton Aargau. Mit Unterstützung der W. Schmid Projekte AG.  
Hauptpartner:



Zürcher  
Kantonalbank



coop energie360°



## Lower ground floor | ARENA

### Special facilities

Direct ramp access to Arena	Height 3.10 m
Vehicle lift	Up to 4 t, direct access to Arena, height 2.30 m
<b>Platform lift</b>	<b>Width 5 m x depth 2.4 m x height 2.3 m</b>
Temporary test track for two-wheelers and four-wheelers	Approx. 240 m

### Technical facilities

<b>Audio</b> public address system for announcements and background music
4 Fohhn LX-600 SW line source loudspeakers
2 Fohhn LX-150 SW line source loudspeakers
1 controller
1 Sennheiser SKM300 wireless hand-held microphone
<b>Line array*</b>
<b>Umwelt Arena DPA 4066 headset microphone</b>
DPA 4066 omnidirectional condenser, beige
<b>Umwelt Arena dual-channel wireless microphone</b>
Sennheiser 550 G2 dual-channel receiver in case incl. 2 hand-held transmitters
SKM 935 G2 + 2 bodypack SK 500 G2/frequency range: 786-822 MHz
<b>Umwelt Arena Yamaha 01V96i digital mixing console</b>
<b>Video projection</b>
1 Panasonic PT-DS20 video projector (20,000 ANSI lumens, resolution 1400 x 1050 pixels)
1 MacBook Pro media PC
1 Panasonic ET-D75LE8 lens, 7.9-15/1
<b>White light with dimmer function</b>
80 LED moving-head white spotlights, variable colour temperature, DTS NICK NRG
<b>Umwelt Arena stage lighting</b>
10 ETC S4 LED Daylight profile spotlights, 26" (incl. truss)
1 light scene programming control (extendable)
<b>Screen</b>
1 motorised screen, 620 cm x 387.5 cm
<b>Truss system, Arena entrance end</b>
1 FD34 mobile truss, 26 m long
1 FD34 static truss, 24 m long
2 FD34 static trusses, each 6.5 m long
1 FD34 mobile truss, 15 m long
<b>Truss system, Arena stage end</b>
1 FD34 mobile backstage truss, 18 m long
2 FD34 mobile stage front trusses, 29 m long
1 FD34 static truss, 27 m long
<b>Stage (standard size 10 x 8 m = 80 m<sup>2</sup>)</b>
Rostrum 10 x 8 m, height 80 cm, 1 stairway
Black stage edging: per module (2 x 1 m)
<b>Furniture</b>
High bistro table (diameter 80 cm)
Conference room table (75 cm x 150 cm)
Conference room chair
Gala-style table (diameter 172 cm)
Further facilities by arrangement with technical systems partner Habegger AG
<b>Wireless LAN</b>

\*16 d&b T10 loudspeakers (2 line arrays with 8 speakers each), passive 2-way, dispersion angle: 90 x 35 degrees, rated load: 200 watt, dimensions: 470 x 197 x 300mm (WxHxD), weight per speaker: 11 kg. 8 d&b Q-Sub loudspeaker; power handling capacity: 400/1600 W (RMS / peak), components: 1 x 18" loudspeaker. 2 d&b Q7 loudspeakers incl. hinged handle (delay line); power handling capacity: 400/1600 W (RMS / peak); nominal dispersion angle: 75° x 40° (h x v); components: 2 x 10" loudspeakers / 1.3" compression driver, 4 d&b E3 full-range loudspeakers (near field); power handling capacity: 120/480 W (RMS / peak); nominal dispersion angle: 90° x 60° (h x v); components: 6.5" / 1" loudspeaker, 2 d&b D12 triple-rack 1200 W amplifiers, 2 x 1200 W / 4 ohm, NL4 outputs, 1 d&b E-Pac amplifier system, dual case for E3, 2 x d&b E-Pac; rated output power: per unit 1 x 300 W / 8 ohm, 1 x 150 W / 4 ohm. 1 d&b remote R60 1 x Z61100.001; peak USB to CAN Interface; 1 x Z6117.000 D-SUB 9 F to 2 x RJ 45 F CAN adapters, 1 system laptop, 2 d&b T-series flying frame loudspeakers

## SEATING EXAMPLES

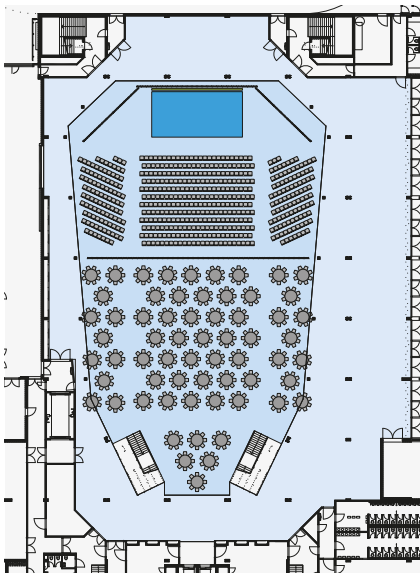

Concert/gala-style seating for approx. 1000 people

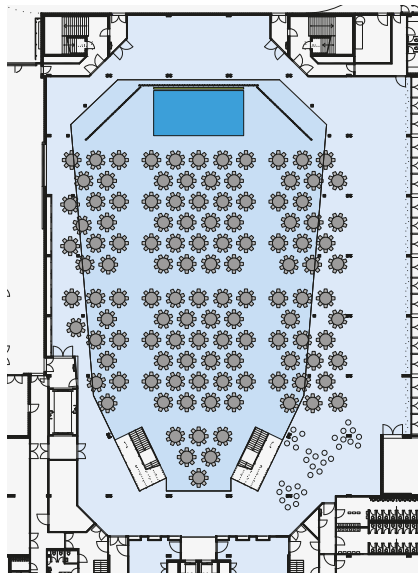

Gala-style seating for approx. 1000 people

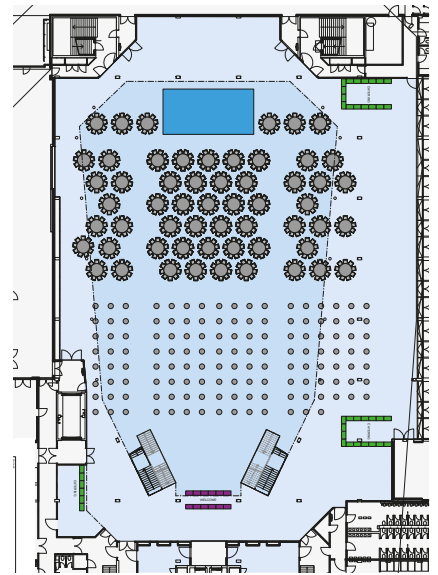

Gala-style seating/aperitif reception for approx. 530 people

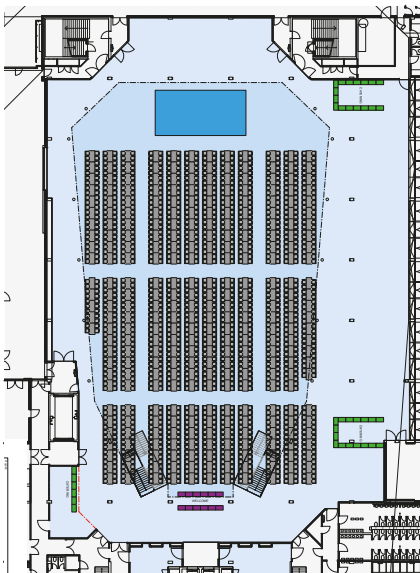

Banquet seating for approx. 1500 people

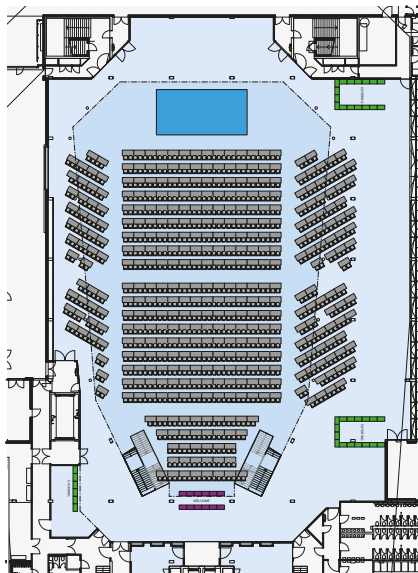

Conference seating for approx. 1000 people

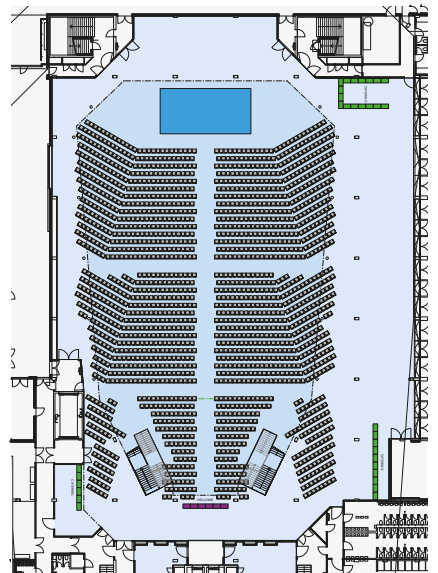

Concert seating for approx. 2000 people

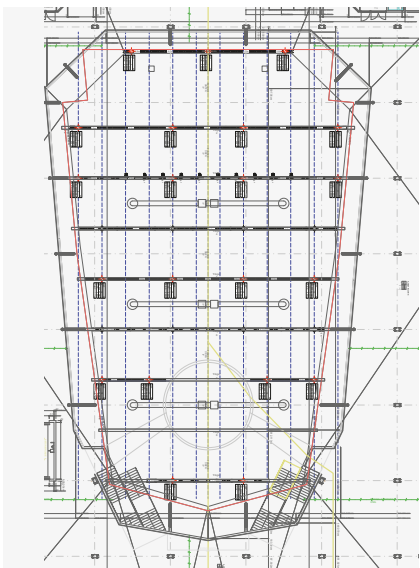

Rigging layout



## References | Events at Umwelt Arena Spreitenbach



Climate Pioneers, Swisscom, November 2012, 1600 people

Since it opened on 24 August 2012 the Umwelt Arena has become an established venue for companies, event organisers and private individuals looking to put on a spectacular event in a fitting location. In the first four months alone the Umwelt Arena

hosted over 400 events. During this time some 50,000 visitors sampled the unique atmosphere and took in the impressive architecture. Around 500 guided tours were also conducted through the 40 exhibitions by expert guides.

### Impressions of past events



Solar awards ceremony, Swiss Solar Agency  
October 2012, 360 people



Customer appreciation day, Cofely AG  
October 2012, 500 people



AboutFleet, A+W Medien AG  
November 2012, 450 people



AMAG Christmas party  
November 2012, 900 people



Schweizer Illustrierte - Car of the Year, Ringier  
November 2012, 300 people



Toyota dealer conference  
December 2012, 400 people



Axpo Holding Christmas party  
December 2012, 1600 people



Customer appreciation day, Sto AG  
January 2013, 550 people



SME Sustainability Award, Zürcher Kantonalbank  
January 2013, 450 people

[www.umweltarena.ch](http://www.umweltarena.ch)  
[www.facebook.com/umweltarena](https://www.facebook.com/umweltarena)



Patronat: Kanton Aargau. Mit Unterstützung der W. Schmid Projekte AG.  
Hauptpartner:

